



Quality Frame Tents for Rental and Commercial Industries

CALL US: 800-997-8368

EMAIL: sales@centraltent.com

Georgia Location: 889 Industrial Blvd Ringgold, GA 30736

Texas Location: 5911 Hamblen Dr, Humble, TX 77396, United States

30x50 Frame Tent Setup Instructions

Step-by-Step Instructions

1. Site Preparation: Select a flat, level surface. Remove debris, sharp objects, and ensure adequate clearance around the setup area.
2. Layout Frame: Place all base plates at correct spacing (corners and intermediate legs). Lay perimeter pipes connecting all base plates loosely.
3. Assemble Perimeter: Connect all perimeter tubing fully and secure with pins/bolts. Ensure all corners are square.
4. Install Rafters: Insert all rafters from perimeter to center ridge. Ensure each connection is properly pinned and seated.
5. Install Center Supports: Connect ridge/center pipes and any cross cables. Tighten cables evenly to create structure tension.
6. Square the Frame: Measure diagonals corner-to-corner. Adjust until both measurements match to ensure the frame is square.
7. Pre-Tension Check: Verify all bolts, pins, and fittings are secured. Do not proceed if any connection is loose.
8. Lift Frame: With crew evenly distributed, raise the frame gradually. Lift opposite sides evenly to avoid

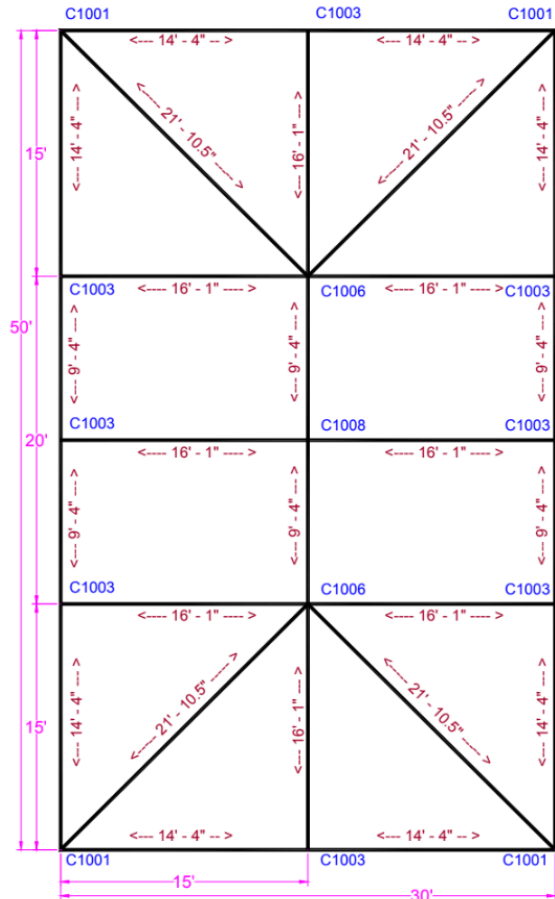

twisting.

9. Install Legs: Insert legs into base plates one side at a time. Continue raising until all legs are vertical.
10. Anchor Tent: Immediately secure each leg using stakes or weights (minimum 500 lbs per leg; more for high wind areas).
11. Install Tent Top: Pull fabric evenly over frame. Align corners first, then secure perimeter.
12. Final Tensioning: Tighten ratchets/ropes evenly on all sides. Ensure fabric is smooth with no sagging.
13. Final Inspection: Check all anchors, fittings, cables, and fabric tension before use.

■ Safety Requirements

- Minimum anchoring: 500 lbs per leg (recommended 900–1200 lbs for higher wind resistance)
- Never leave tent partially assembled or unsecured
- Do not install in unsafe weather conditions (high wind, lightning)
- Always use trained crew for lifting operations
- Inspect all components before each use